



enfields

Enfields Hythe  
3 Marsh Parade,  
Hythe, Southampton,  
Hampshire, SO45 6AN

T 023 8084 9210  
E sales-hythe@enfields.co.uk

## 22 Velsheda Court, Hythe

Guide Price £700,000 - £730,000

🛏 5 🚿 3 🚗 0



- NO FORWARD CHAIN
- PRIVATE 10M MOORING
- DIRECT VIEWS OVER THE SOUTHAMPTON WATERS
- POSSIBILITY FOR A 17M MOORING
- FULL FLOOR PRIMARY SUITE
- GREAT LOCATION
- 5 BEDROOMS
- GARAGE + PARKING + EV CHARGER
- 2 EN-SUITS + FAMILY BATHROOM + WC
- CALL TODAY TO BOOK A VIEWING



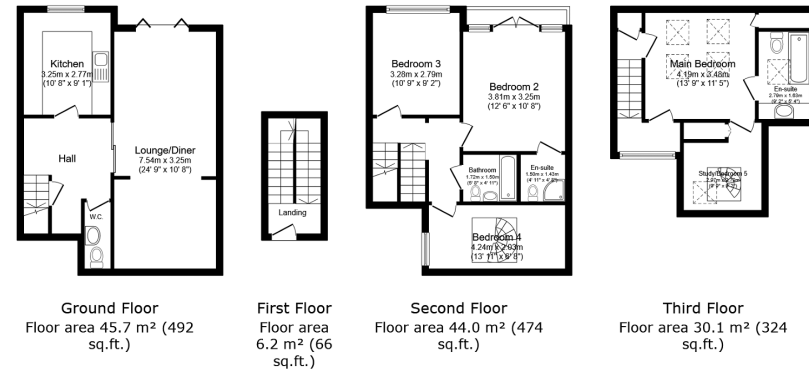

TOTAL: 126.0 m<sup>2</sup> (1,356 sq.ft.)

This floor plan is for illustrative purposes only. It is not drawn to scale. Any measurements, floor areas (including any total floor area), openings and orientations are approximate. No details are guaranteed, they cannot be relied upon for any purpose and do not form any part of any agreement. No liability is taken for any error, omission or misstatement. A party must rely upon its own inspection(s). Powered by www.Propertybox.io

GUIDE PRICE OF £700,000 - £730,000

Lovely 5 bedroom Marina Home with direct views of the Southampton Waters!

Bifold doors leading out to the sunny garden with your own private 10m mooring. Perfect to sit outside with your morning tea or coffee.

This house also comes with the possibility for an additional 17m mooring for those who have a bigger boat.

